

Traffic and Travel



The amount of traffic is the only thing that residents really don't like about living in Broomfield. Some level of traffic is inevitable, but we would like to reduce it - and reduce its impact on village life.

So, in the Plan we are trying to:

- Create more safe, viable alternatives for local people to walk, cycle or use the bus if they wish to
- Make School Lane and Main Road less attractive as rat runs for through traffic, and so encourage through traffic to use Essex Regiment Way instead
- Reduce the **impact** of traffic on the village – for instance through new crossings so that the two halves of the village are more joined together and accessible for local residents.

New Foot and Cycle Paths

The Plan contains an outline strategy to increase walking and cycling, mainly through developing a network of new, safe foot and cycle paths. Our current ideas for the whole network are shown on the first map below, but the lack of funding means that it could only be achieved in stages over a period of several years. There would be a lot more consultation before each section was built – so if circumstances change, that can be taken into account at the time.



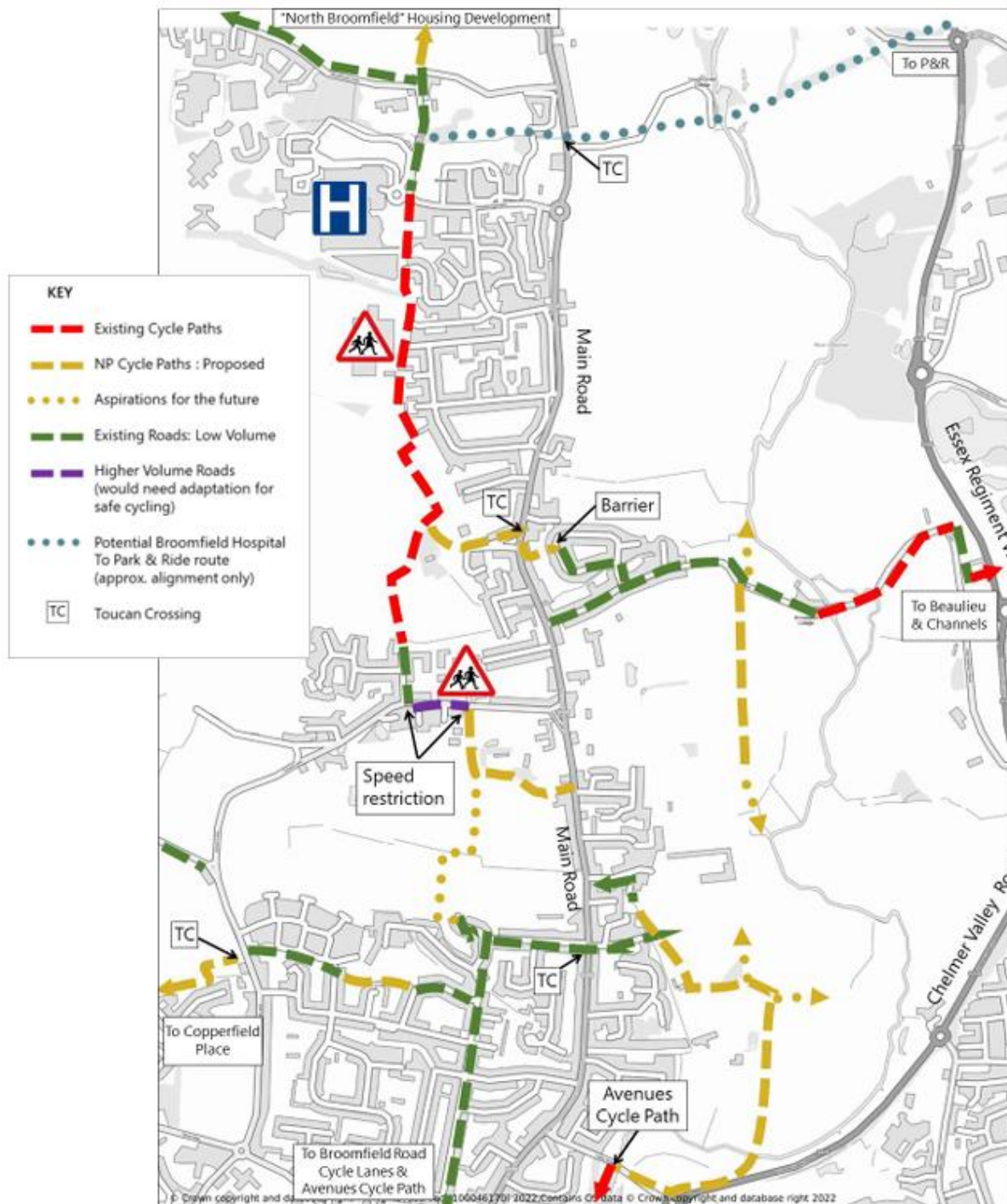

Fig 14 - Neighbourhood Plan Proposals for New Cycle Routes

More Crossings

The next map shows current suggestions for new crossing points. As well as helping residents to cross safely, they should also make Main Road less desirable as a short cut for through traffic as it could take a bit longer to speed through the village than it does at the moment:

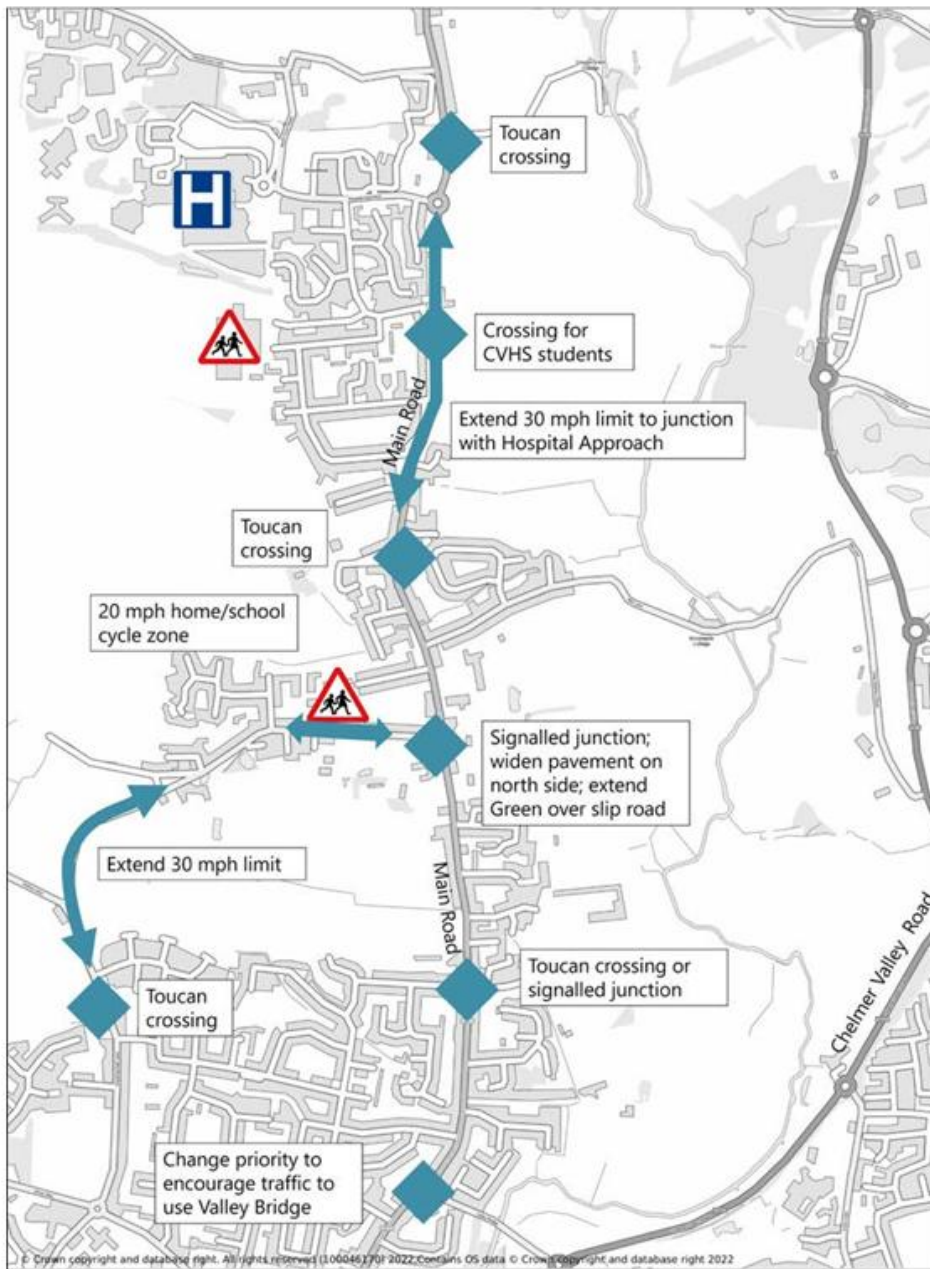

Fig 15 - Suggestions for traffic mitigation (larger scale maps can be found on the Neighbourhood Plan website)

Again, please note that both maps show **current** proposals. They will inevitably evolve as new opportunities come and go. Plus, they are dependent on achieving funding and final approval from Essex Highways.

[Read the full chapter on Traffic and Travel](#)